

SONITUS

## About

**Sonitus** is a full-service audio and video consulting company specializing in acoustic theatrical sound design, high-performance audio and video presentation and broadcast systems. We have extensive experience working in performing arts centers, indoor and outdoor concert venues, film and video studios, recording facilities and other demanding creative environments.

**Sonitus** combines a comprehensive blend of artistry and engineering, creativity and technology, authority and experience for precise sonic and visual production environments. Our methods are process driven with an emphasis on delivering high quality, measurable and repeatable results through systematic analysis.

**Sonitus** applies its design philosophies to areas outside of the performing arts by creating audiovisual systems for corporate, educational, retail, hospitality, institutional and public/civic facilities.

**Sonitus** has forged strategic alliances with specialists in the fields of concert sound, record and broadcast engineering, DSP processing, sound prediction, display technologies and other relevant disciplines. Each Sonitus specialist can be drawn upon for superior advice as dictated by the individual project.

**Sonitus'** design philosophy brings together active professionals in audio, video and broadcast to ensure practical solutions, using proven and emerging technologies, systems, and workflow concepts.

## Services

### Consulting

- Feasibility Studies
- Program and Budget Development
- Contract Documents, Tendering, Bid Analysis and Selection
- Project Management and Compliance
- Facilities Assessment and Programming Studies
- Systems Evaluation and Calibration
- Technical Training

### Design

- Systems Design – Product or Performance based
- Predictive Modeling
- Infrastructure
  - Conduit and cable management
  - Technical power and heat loading

### Systems

- Audio visual
- Performance sound, video and communications
- Video and broadcast
- Digital signage
- Audio/video conferencing

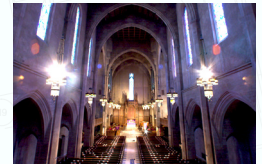

**Sonitus**

Los Angeles, CA

310.837.0807

[www.sonitusconsulting.com](http://www.sonitusconsulting.com)

## Selected Experience

### Performing Arts Centers

Bing Concert Hall  
Lotte Concert Hall  
Centro Cultural Corpates  
Chapman University Center for the Arts  
Colburn School for the Performing Arts  
Dorothy Chandler Pavilion  
Guggenheim Museum, Abu Dhabi  
Harman Hall  
Herb Alpert Educational Village  
Hollywood Bowl  
New World Center  
Norris Center For the Performing Arts  
Miami SoundScape  
San Francisco State University Creative Arts Center  
Soka University Performing Arts Center  
USC Brain and Creativity Institute  
Walt Disney Concert Hall

### Higher Education

Stanford University, Bing Concert Hall  
Chapman University, Center for the Arts  
Chapman University, School of Music  
Colburn School for the Performing Arts  
Harman Hall  
New World Center  
Ostin Music Center  
San Francisco State University Creative Arts Center  
Soka University Performing Arts Center  
USC Brain and Creativity Institute  
USC School of Music

### K-12 Education

Stephen Weiss High School  
Ramon C. Cortines School Of Visual And Performing Arts  
Herb Alpert Educational Village

### Worship

First Congregational Church of Los Angeles  
Stanford University, Memorial Church

### Recording Studio, Broadcast & Media Production

Chapman University School of Music  
Helms Hall Studios  
Ostin Music Center  
San Francisco State University Creative Arts Center  
USC School of Music

### Other

Star Wars in Concert  
Federal Reserve Bank of San Francisco, Conference Center  
Long Beach Mobile Arts Project  
Santa Susana High School  
Westridge School for Girls



**Sonitus**

Los Angeles, CA

310.837.0807

[www.sonitusconsulting.com](http://www.sonitusconsulting.com)

## Fred R. Vogler, Principal

Sonitus embodies the culmination of Fred's experience as principal sound designer and lead mixer for numerous productions of "live" concerts at amphitheaters, concert halls, arenas and various performance venues. Fred has extensive experience recording symphonic, operatic and choral ensembles for film, compact disc and radio broadcast for artists such as the Los Angeles Philharmonic, Los Angeles Opera, Los Angeles Master Chorale and Mormon Tabernacle Choir.

Through Sonitus, Fred is active in design and management of audio visual systems for clients as wide-reaching as New World Symphony in Florida, Stanford University in Palo Alto and CorpArtes in Santiago, Chile. Sonitus focuses on practical and functional solutions with necessary technologies for modern day performing arts. Sonitus believes in consensus building among peers, colleagues and clients to ensure superior design.

Besides his interest in sound wave propagation and system design, Fred is a three time Grammy Award winner. Fred also enjoys working in feature film as a music-scoring mixer for composers such as David Newman (Norbit, Spirit) and Jeff Richmond (Baby Mama). In the past, Fred has worked on-set as music playback/live record engineer for numerous movies including *Sister Act I & II*, *What's Love Got to Do With It*, and *Preacher's Wife*.

Fred has been on the Board of Governors for Los Angeles Chapter of the Recording Academy (NARAS) and is a member of IATSE 700. Fred was on the faculty of the USC Thornton School of Music for six years and the orchestra mixer for Barbra Streisand's tours in 1993-4 and 2000.

### Education:

Master of Arts: 1990, Annenberg School of Communication, University of Southern California

Bachelor of Science: 1988, Valedictorian, Thornton School of Music, University of Southern California

Valedictorian in 1988 and Alumnus of the Year in 2008 from USC Thornton School of Music.



**Sonitus**

Los Angeles, CA

310.837.0807

[www.sonitusconsulting.com](http://www.sonitusconsulting.com)



## Tim Boot, Principal

Tim Boot has been involved in the professional production of the arts throughout his 20-year career. While his primary focus has been in audio, he has extensive experience in lighting, stagecraft, cinematography, broadcast and video. This experience encompasses all of the live performing arts: theatre, opera, music, dance, motion picture and special event recording. He has worked with organizations such as the Los Angeles Philharmonic, the Los Angeles Opera, the Pacific Symphony, and many other artists and organizations who demand the highest level of professionalism and true fidelity in product and systems.

Design and integration of audio, video and communications systems is a special interest of Tim's which led to a partnership in the late 1990s with the theater design firm JK Design Group. This early work showed Tim's desires to apply his current practical experience to the field of installed audiovisual systems, a belief that continues to drive his current and future designs. In fact, Tim's design experience has taken him beyond the performing arts. He has successfully applied his real world experience in high-performance systems and work flows in post-production facilities and corporate audio-visual systems.

Tim is an award winning motion picture music editor and music-mixing engineer. (Golden Reel, "Dreamgirls"). His experience includes 15 years of audio and music work for motion picture production and post-production for Disney, Paramount, Universal, Sony, Fox and other major studios.

Tim is the founding principal of Sonitus and is involved in all projects as part of management, design and integration. Tim firmly believes Sonitus' approach to design and consulting, which relies on common practice with state-of-the-art and proven technologies, is the only way to create systems and working environments that meet the clients' needs.

### Experience:

KHz Design: 2009-present

Sonitus: Principal 2006-present

TB Audio Design: Principal 1998-present

Chapman University: Instructor 2005-2006

Liquid Music: Music Editor, Technical Director 2004-2006

Segue Music: Music Editor, Technical Director 1996-2000

UCLA Center for the Arts: Stage Technician 1990-1996

Norris Center for the Arts: Assistant Technical Director 1988-1994

Affiliations: AES, NAB, IATSE Locals 700 and 695



**Sonitus**

Los Angeles, CA

310.837.0807

[www.sonitusconsulting.com](http://www.sonitusconsulting.com)

# Hollywood Bowl

Hodgetts & Fung Architects, May '04 – \$25M

The 18,000 seat Hollywood Bowl is largest natural amphitheater in the U.S. This iconic, outdoor concert venue has been summer home of the Los Angeles Philharmonic since 1922. With almost one million attendees recorded annually, featured performances include classical, jazz, world, pop and rock music.

At the conclusion of the Hollywood Bowl's 2003 season, construction began to replace the old shell and backstage areas with completely redesigned shell and modern, state-of-the-art facilities. As planned, the new shell was opened in time for the 2004 season starting in June. Sonitus was the principal sound system and audio infrastructure design consultant for the project. As part of Los Angeles County's Park and National Historical Landmark Society, the efforts to complete the project on time, while meeting all of the necessary scope and programming demands, were epic. Annually the Bowl is host to artists as varied as the Rolling Stones, Diana Krall, Femi Kuti and the Hollywood Bowl Orchestra.

As an indicator of the project's success, the Bowl's transformation has resulted in five consecutive years as Pollstar's Best Major Outdoor Concert Venue – an award never received before the renovation. Sonitus' relationship with the Bowl is on-going and provides direction for system upgrades and improvements to the acoustic environment both on-stage and in the house. In addition, Sonitus plays an important role helping to organize and design systems to mitigate sound wave transmission into the Bowl's neighboring communities. Such design has led to the "sound mitt" construction on top of one of the concession stands, which catches and attenuates sound before traveling to homes in the community. Sonitus contributes by anticipating future technical and acoustic needs of the modern day icon.



**Sonitus**  
Los Angeles, CA  
310.837.0807  
[www.sonitusconsulting.com](http://www.sonitusconsulting.com)

# Walt Disney Concert Hall

Gehry Partners LLP, September '05 – \$270M

The Walt Disney Concert Hall is the home of the Los Angeles Philharmonic Orchestra. As one of the most modern, sophisticated concert halls in the world, the visual and aural intimacy provides patrons with a unique musical experience and highlights the creative spirit in the city of Los Angeles.

Opened in 2005 the two thousand, two hundred and sixty five seat main auditorium surrounds the orchestra and audience with non-parallel surfaces in the look and feel of a ship's hull. Included in the facility are two outdoor amphitheaters and an indoor, pre-concert event space with supporting practice, technical rooms and offices for the administration.

As principal sound design consultants for a custom sound system, Sonitus has matched modern performance technology within a highly aesthetic and acoustic environment. The results continue to provide audiences with exciting and engaging concert productions. Sonitus maintains a position for audio consultation and support for the Los Angeles Philharmonic's eclectic and demanding programming.



**Sonitus**  
Los Angeles, CA  
310.837.0807  
[www.sonitusconsulting.com](http://www.sonitusconsulting.com)



# New World Symphony

Gehry Partners LLP, September '10 – \$75M

One of the goals of New World Symphony (NWS) is to “produce musicians who are leaders in the full-sense of the word.” As one of the country’s prestigious music universities, the curriculum exposes young musicians to top level artists in a variety of musical genres. However, NWS goes beyond the traditional conservatory.

Recently completed is NWS’ ninety-thousand square foot home on Lincoln Road in Miami Beach. The new facility features a seven hundred seat concert hall, rehearsal, practice and instructional rooms, offices and technical support spaces to help NWS “become a global hub for creative expression and collaboration, and a laboratory for generating new ideas about the way music is taught, performed, and experienced.”

Sonitus, as concept sound designer and audio systems consultant, is proud to be a part of such a forward-leaning production complex. A unique system design involves custom in-wall loudspeaker components to compliment flexible surround video projection within the main hall. The high level technology will appropriately support the high performance acoustic environment. In addition to sound design, Sonitus is also helping organize systems for recording and Internet2 broadcast.

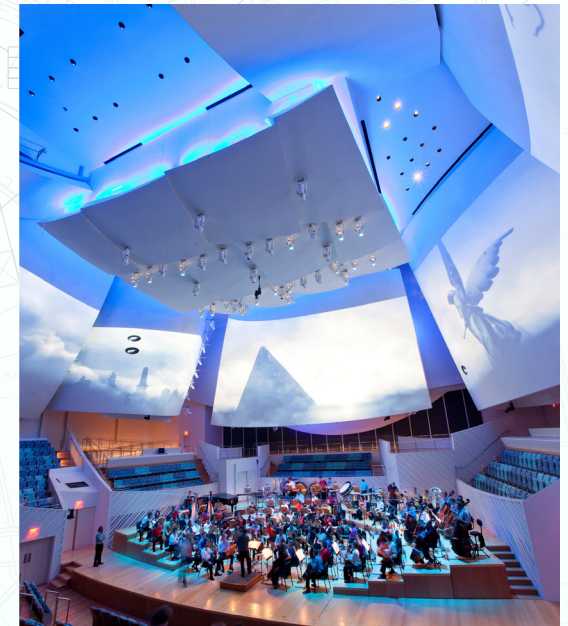

**Sonitus**  
Los Angeles, CA  
310.837.0807  
[www.sonitusconsulting.com](http://www.sonitusconsulting.com)



# Musco Center for the Arts

Pfieffer Partners Architects, 2015 – \$64M

The Musco Center for the Arts will benefit both the campus and the surrounding community as a venue for performance, instruction and the arts. The 1,050-seat Musco will be equipped with state-of-the-art facilities for the Chapman orchestra and theater department, as well as amenities for other events and uses, including the city of Orange.

The new facility will enhance the Chapman experience on campus, particularly for students at the College of Performing Arts, build bridges to the vibrant Orange County arts community, and elevate the college to new heights and prominence. It will allow the university to present world-class performances of opera, musical theatre, symphony, theatre and dance.

The center will also fulfill a critical need for increased rehearsal and performance space on campus. Existing arts education programs will find renewed energy as the limitations imposed by the present facilities are lifted and new possibilities for creative expression surge.

Sonitus has designed a highly integrated and high-performance audio, video and broadcast system to support productions and events and share and collaborate with audiences and performers across the world. Sonitus worked with the university, the design team and the donor to create one of the most advanced systems in the region. The sound system is designed to compliment the high performance acoustics of the center. Video and Broadcast systems will allow for in-house and outside broadcast entities to capture and transmit events to a wider audience. High-definition, multi-camera systems also allow collaborative events utilizing Internet2 and other connection technologies.



**Sonitus**  
Los Angeles, CA  
310.837.0807  
[www.sonitusconsulting.com](http://www.sonitusconsulting.com)

# SOKA University of America

Zimmer Gunsul Frasca Architects, September '10 – \$70M

SOKA University promotes “an appreciation for the universal human creative spirit” and enhancement in creative thinking and problem solving through art. The rigorous academics and international liberal arts education help prepare students for future enterprise, including roles in global leadership.

The new complex consists of a three-level performing arts center and features a multipurpose theatre and concert hall. As audio, video and communications design consultants, Sonitus created and designed systems to respond to the facility's numerous University sponsored and lease events. Systems must be flexible, yet sophisticated for transitions between spoken word, touring popular music and chamber ensemble concerts. Sonitus designed an extensive and flexible audio, video and production communications infrastructure and systems. The facility includes AV systems for live production support and capture for high-definition television broadcast and commercial recording.



**Sonitus**  
Los Angeles, CA  
310.837.0807  
[www.sonitusconsulting.com](http://www.sonitusconsulting.com)



# Guggenheim Museum, Abu Dhabi

Gehry Partners LLP, 2015 – \$817M

The new Guggenheim Abu Dhabi will be located in the Cultural District of Saadiyat Island in Abu Dhabi, the capital of the United Arab Emirates (UAE). Designed by internationally renowned architect Frank Gehry, the 450,000-square-foot museum will house its own major modern and contemporary art collection and present special exhibitions that will include works from the Guggenheim Foundation's extensive collection. The museum, the largest Guggenheim in the world, will have global art, exhibitions and education programs with particular focus on Middle Eastern contemporary art. The Guggenheim Abu Dhabi joins other leading international cultural institutions in the unprecedented creation of a vibrant cultural destination for visitors from around the world.

Sonitus, as concept AV designers and systems consultant, is involved in the AV systems in the theatre, event spaces, galleries and in other museum-wide spaces. The high level of technology and infrastructure will allow the facility to fully integrate and support gallery installations, special events and a wide range of performing arts. In addition to event and curatorial needs, Sonitus is providing guidance for television, radio and other media broadcast support.

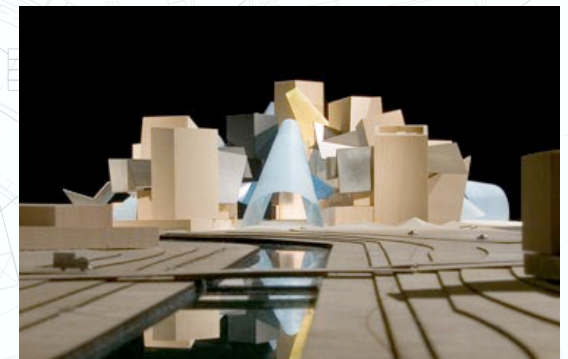

**Sonitus**  
Los Angeles, CA  
310.837.0807  
[www.sonitusconsulting.com](http://www.sonitusconsulting.com)



# Stanford University, Bing Concert Hall

Ennead Architects, January '13 – \$75M

The 844-seat Bing Concert Hall will be an acoustically exceptional hall, well suited for a range of music groups from small chamber ensembles to medium-sized orchestras. The concert hall will present visiting artists in an environment ideally suited to their art and will potentially give Stanford the reputation for being one of the country's premier presenters of chamber, recital, and world music.

As audio system designers and consultants, Sonitus has developed a custom loudspeaker system to complement the hall's acoustics. Sonitus has also designed a highly flexible audio infrastructure and systems with a recording suite, control rooms and front-of-house and back-of-house systems.



**Sonitus**  
Los Angeles, CA  
310.837.0807  
[www.sonitusconsulting.com](http://www.sonitusconsulting.com)

# Miami SoundScape / Lincoln Park

west8, January '11

SoundScape, the immersive audio experience which brings the indoor acoustics of the Concert Hall to the outdoor beauty of South Beach, Florida, entertains park audiences with spectacular visuals and comprehensive immersive surround audio. Sonitus designed the unique sound system for the park consisting of 167 loudspeakers, processing and the network of microphones and systems within the hall which captures the performance and acoustic characteristics. The park's prime listening area, which accommodates more than 1000 people, is located adjacent to the Frank Gehry designed New World Center, for which Sonitus was the concept audio designer.

The WallCast events, where concerts from within the New World Center are projected on a 100' x 70' wall of the new building and feature SoundScape audio, are presented to the public free of charge. The first several concerts have received critical acclaim by the New York Times stating, "The big news here is the high quality of the sound, the best outdoor amplification I have ever heard," and the New Yorker, among many other publications.

The new park has quickly become a tremendous asset to the City of Miami. Success of this system is also credited to Pro Sound and Video of Miami, Florida and Meyer Sound Laboratories of Berkeley, California. Sonitus is thrilled to be part of the New World Symphony project and believes it is the beginning of an enhanced way to experience the performing arts.



**Sonitus**  
Los Angeles, CA  
310.837.0807  
[www.sonitusconsulting.com](http://www.sonitusconsulting.com)



# University of California, Los Angeles Ostin Music Center

Daly Genik Architects, February '14

The Ostin Music center is a new addition to the music facilities at UCLA. The centerpiece of this new project is a commercial quality recording studio. In addition there will be a new cafe with performing space, a rehearsal hall, faculty studios, audio post-production suites and additional mixing room. Sonitus is the studio planning consultant and the audio and video design/consultant for the project.

To create a world -class caliber recording studio Sonitus worked with the architect to create a space that will welcome professional recording engineers and producers as well as the faculty, staff and students of the university. Sonitus' goal was to create an intimate and private studio where artists are able to express there musical creativity. While maintaining this intimacy the live room is also capable of recording up to 40 musicians and the control room is large enough to accommodate numerous production personnel. All of these spaces were also designed to accommodate small numbers of students when the studio is utilized as a teaching space.

Sonitus has designed and specified the recording systems and infrastructure to meet the standards for modern studio production and collaboration.





# University of Southern California Brain and Creativity Institute

Perkins + Will, March '12

USC's Brain and Creativity Institute building is a new addition to the USC campus. The building includes a 110 seat concert hall designed by renown acoustician Yasushia Toyota of Nagata Acoustics. This exciting and intimate new venue will showcase various music ensembles, lectures, guest speakers, screenings and numerous other events in support of the institutes research goals. Sonitus was tasked with designing a high performance audio system for presentation and amplification of live events, lectures and screenings. In addition to video presentation systems the hall also includes numerous robotic cameras for small-scale broadcast, archival and Internet2 collaboration.

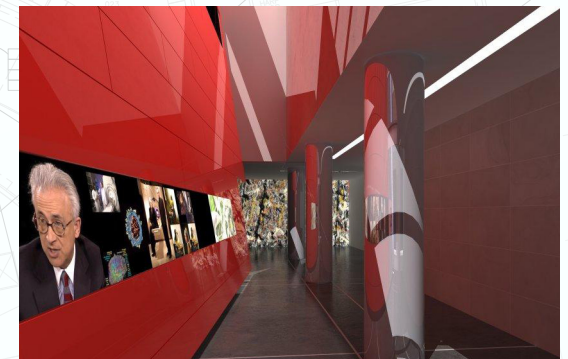

**Sonitus**  
Los Angeles, CA  
310.837.0807  
[www.sonitusconsulting.com](http://www.sonitusconsulting.com)

# The Colburn School of the Performing Arts

Pfieffer Partners Architects, August '07 – \$120M

The Colburn School is one of the top music conservatories in the country and a premiere performing arts school in Los Angeles. Students participate in recitals, showcases and concerts throughout the year in preparation for careers in the arts.

The campus expansion of 2007 connected an existing school facility with a new three hundred and twenty six thousand square foot, twelve-story high rise. Included in the addition are fifty new practice rooms, four classrooms, a two hundred seat concert hall, a four thousand square foot rehearsal hall, residential housing for more than a hundred students and a café that is open to the public.

Sonitus designed an audio visual infrastructure and systems to interconnect the performing spaces with existing and new AV systems to support the more than two hundred annual events. The campus' two concert halls, three recital rooms, and instructional, technical and mastering labs, realize audio and video connectivity through fiber and CAT6 wiring. Sonitus continues to provide consultation with the school helping to respond to the high demands of combining instruction and performance.



**Sonitus**  
Los Angeles, CA  
310.837.0807  
[www.sonitusconsulting.com](http://www.sonitusconsulting.com)

# First Congregational Church of Los Angeles

The First Congregational Church of Los Angeles is the oldest Protestant church in continual operation in all of Los Angeles. The church's cathedral style Gothic revival building was finished in 1932. It includes the sanctuary, chapel, school and numerous event spaces.

The Church houses one of the world's largest operational pipe organs and its excellent acoustics has developed its status as a sought after venue for music performances and festivals. Its classic architecture is also a draw for film productions which use the space frequently as a filming location.

Sonitus was asked design a replacement for the existing audio and video systems, which had been pieced together over the years. The existing system was a distributed array of speakers and components, with significant shortcomings, primarily in intelligibility beyond the first few pews. The church was also desiring to increase the flexibility and overall quality to meet the needs of more contemporary services. The challenge for Sonitus was to design a system that met the performance goals and worked in harmony with the building's complex acoustics without adversely affecting them. Additionally, the equipment and infrastructure upgrades could not damage the original stone and woodwork or alter the visual aesthetics of the space.

The new system has exceeded all expectations, high quality sound reinforcement reaches all areas of the sanctuary. Sonitus continues to provide audiovisual system design and consultation to other areas of the church.



**Sonitus**  
Los Angeles, CA  
310.837.0807  
[www.sonitusconsulting.com](http://www.sonitusconsulting.com)